

# Stainless Steel Reali-Slim® Bearings

## Type A

### Angular Contact

SAA10AG0

| SAA SERIES (3/16" cross-section) |                      |                  |                          |                          |                            |                        |      |                     |      |                  |
|----------------------------------|----------------------|------------------|--------------------------|--------------------------|----------------------------|------------------------|------|---------------------|------|------------------|
| Kaydon Bearing Number            | Dimensions in Inches |                  |                          |                          |                            | Capacities in Pounds ① |      |                     |      | Weight in Pounds |
|                                  | Bore                 | Outside Diameter | Land Dia. L <sub>1</sub> | Land Dia. L <sub>2</sub> | C'Bore Dia. L <sub>3</sub> | Radial                 |      | Thrust              |      |                  |
|                                  |                      |                  |                          |                          |                            | Static <sup>②</sup>    | Dyn. | Static <sup>②</sup> | Dyn. |                  |
| SAA10AG0                         | 1.000                | 1.375            | 1.140                    | 1.235                    | 1.274                      | 340                    | 150  | 970                 | 450  | .025             |
| SAA15AG0                         | 1.500                | 1.875            | 1.640                    | 1.735                    | 1.774                      | 480                    | 300  | 1,380               | 560  | .038             |

Circular pocket separator 3/32" balls

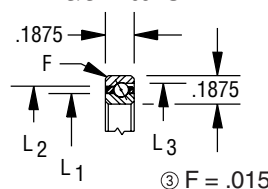

| SA SERIES (1/4" cross-section) |                      |                  |                          |                          |                            |                        |      |                     |       |                  |
|--------------------------------|----------------------|------------------|--------------------------|--------------------------|----------------------------|------------------------|------|---------------------|-------|------------------|
| Kaydon Bearing Number          | Dimensions in Inches |                  |                          |                          |                            | Capacities in Pounds ① |      |                     |       | Weight in Pounds |
|                                | Bore                 | Outside Diameter | Land Dia. L <sub>1</sub> | Land Dia. L <sub>2</sub> | C'Bore Dia. L <sub>3</sub> | Radial                 |      | Thrust              |       |                  |
|                                |                      |                  |                          |                          |                            | Static <sup>②</sup>    | Dyn. | Static <sup>②</sup> | Dyn.  |                  |
| SA020AR0                       | 2.000                | 2.500            | 2.186                    | 2.314                    | 2.369                      | 790                    | 330  | 2,280               | 960   | .10              |
| SA025AR0                       | 2.500                | 3.000            | 2.686                    | 2.814                    | 2.869                      | 960                    | 380  | 2,780               | 1,100 | .12              |
| SA030AR0                       | 3.000                | 3.500            | 3.186                    | 3.314                    | 3.367                      | 1,140                  | 430  | 3,290               | 1,230 | .14              |
| SA035AR0                       | 3.500                | 4.000            | 3.686                    | 3.814                    | 3.867                      | 1,310                  | 470  | 3,790               | 1,350 | .17              |
| SA040AR0                       | 4.000                | 4.500            | 4.186                    | 4.314                    | 4.367                      | 1,490                  | 510  | 4,300               | 1,470 | .19              |

Circular pocket separator 1/8" balls

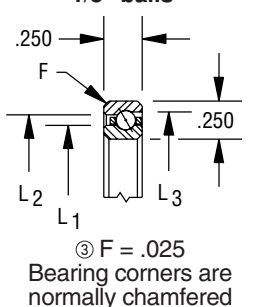

| SB SERIES (5/16" cross-section) |                      |                  |                          |                          |                            |                        |      |                     |       |                  |
|---------------------------------|----------------------|------------------|--------------------------|--------------------------|----------------------------|------------------------|------|---------------------|-------|------------------|
| Kaydon Bearing Number           | Dimensions in Inches |                  |                          |                          |                            | Capacities in Pounds ① |      |                     |       | Weight in Pounds |
|                                 | Bore                 | Outside Diameter | Land Dia. L <sub>1</sub> | Land Dia. L <sub>2</sub> | C'Bore Dia. L <sub>3</sub> | Radial                 |      | Thrust              |       |                  |
|                                 |                      |                  |                          |                          |                            | Static <sup>②</sup>    | Dyn. | Static <sup>②</sup> | Dyn.  |                  |
| SB020AR0                        | 2.000                | 2.625            | 2.231                    | 2.393                    | 2.464                      | 1,090                  | 480  | 3,150               | 1,380 | .15              |
| SB025AR0                        | 2.500                | 3.125            | 2.731                    | 2.893                    | 2.964                      | 1,340                  | 550  | 3,860               | 1,590 | .19              |
| SB030AR0                        | 3.000                | 3.625            | 3.231                    | 3.393                    | 3.462                      | 1,550                  | 610  | 4,470               | 1,750 | .22              |
| SB035AR0                        | 3.500                | 4.125            | 3.731                    | 3.893                    | 3.962                      | 1,790                  | 670  | 5,180               | 1,930 | .27              |
| SB040AR0                        | 4.000                | 4.625            | 4.231                    | 4.393                    | 4.460                      | 2,040                  | 730  | 5,890               | 2,100 | .30              |

Circular pocket separator 5/32" balls

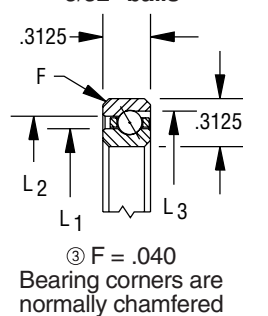

① Capacities listed are not simultaneous. For combined loading see discussion of Bearing Selection and Load Analysis. Dynamic capacities are based upon 1 million revolutions of L10 life. Published capacities do not apply to hybrid series bearings P, X, and Y - contact Kaydon product engineering for values.

② Static capacities are non-brinell limits based on rigid support from the shaft and housing.

③ "F" is the maximum shaft or housing fillet radius the bearing corners will clear.

\* Contact Kaydon for lead time and minimum purchase requirement.