

| PARTS LIST | | | | | |
|------------|-----|-----------|----------|---|-----|
| ITEM | QTY | PART # | VENDOR | DESCRIPTION | REV |
| 2 | 1 | FS-07-008 | | ASSY,COVER/MOTOR/PCB, TOP FW,*8,30/60 | B |
| 2.1 | 1 | FS-07-012 | | ASSY,PCB DECODER,6 REED SW. | A |
| 2.2 | 1 | FS-17-005 | | COVER, TOP,*8,30/60,DECODER BOX | A |
| 2.3 | 1 | PF545-BC | MYCOM | 5 PHASE STEPPER MOTOR | BUY |
| 2.4 | 4 | 92148A150 | McMaster | SPRING-LOCK-WASHER-M3 | BUY |
| 2.5 | 4 | 91292A112 | McMaster | SHCS M3x8mm | BUY |
| 2.6 | 1 | FS-17-011 | (PIC) | MANUAL MOTOR TURN (Make from G48-120) | A |
| 2.8 | 2 | R3 | Champion | FLANGED DOUBLE SHIELD BALL BEARING 0.500 x 0.1875 | BUY |
| 2.9 | 4 | 92510A688 | McMaster | SPACER #4x0.125-AL | BUY |
| 2.10 | 4 | 92146A530 | McMaster | SPRING LOCK WASHER No 4 | BUY |
| 2.11 | 4 | 92196A108 | McMaster | SHCS 4-40 x 0.375 SSTL | BUY |
| 2.12 | 1 | 92778A044 | McMaster | SET-SCREW 4-40 x 0.1875 | BUY |

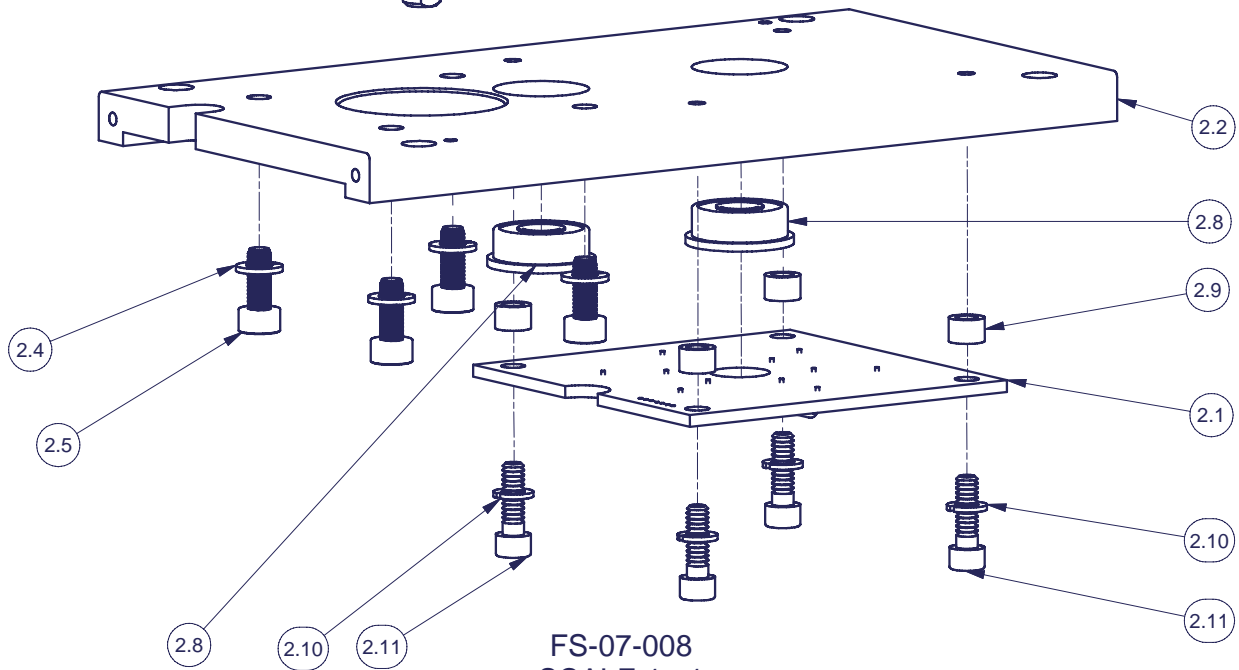

FS-07-008
SCALE 1 : 1